

RoHS

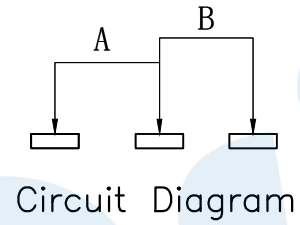

PCB Layout(Pattern side)

Code	H	Operating force
A1	1.5	160±50gf

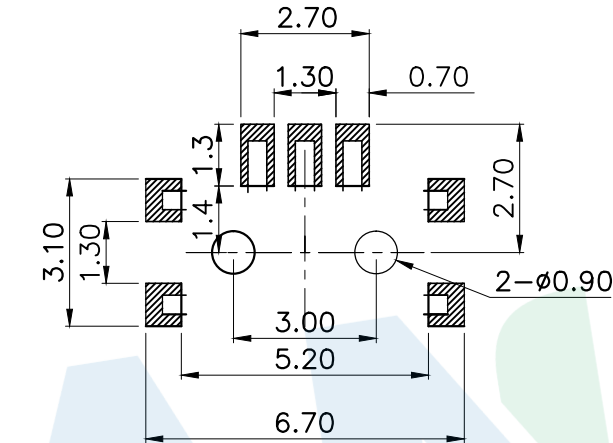
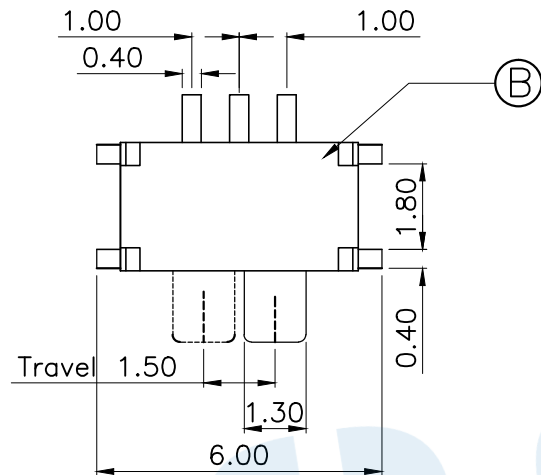
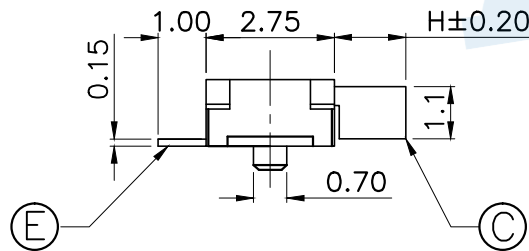
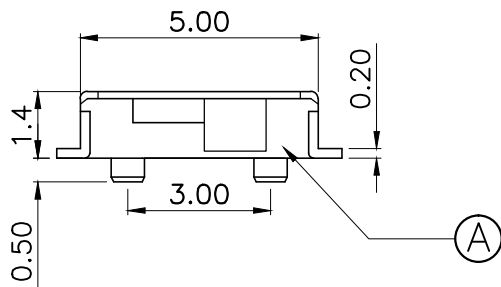

(F)	Spring plate		1	SUS	Natural
(E)	Terminal		3	Brass	Silver
(D)	Contact reed		1	Beryllium copper	Silver covered
(C)	Handle		1	Nylon	Black
(B)	Cover		1	Brass	Silver
(A)	Base		1	LCP	Black
NO.	Name	Number	Qty	Materil	Remarks

YUANDI® Yuandi Electronics Co, Ltd

design	date	name	TOGGLE SWITCH
Review	date	model	TA-3514-A□
Approved	date		

Drawing number: Proportion 1:1 unit mm gage number A4

modify Review Approved Tolerance not specified

angle	±2'
10~30	±0.30
5~10	±0.20
~ 5	±0.10